



**The Spark Festival 2023**  
**City Playground Community Takeover Day**  
**featuring Palaver Party - Visual Story**

**Saturday 18 February**

**Takeover Day - 11am - 3pm | Palaver Party - 2pm – 4pm**



**Box Office Telephone: 0116 242 3595**

**Box Office Email: [tickets@curvetheatre.co.uk](mailto:tickets@curvetheatre.co.uk)**

**Address: Curve, 60 Rutland Street, Leicester, LE1 1SB**

# Contents

|                                                     |         |
|-----------------------------------------------------|---------|
| <b>Hello and What is a Community Day?</b> .....     | 2       |
| <b>Getting to Curve</b> .....                       | 3 - 4   |
| <b>Visual Story: Your Visit to Curve</b> .....      | 5 - 11  |
| <b>Takeover Day Schedule and Activity Map</b> ..... | 12 - 13 |
| <b>Palaver Party: Show Information</b> .....        | 14 - 17 |

## Hello!



We are looking forward to welcoming you to **Curve** for the **City Playground Community Takeover Day** as part of **The Spark Festival 2023!**

This pack will give you more information about the day and our theatre ahead of your visit. So you can familiarise yourself with our building and spaces, we have included maps and pictures throughout, but please note the rooms will look

different when you visit us on the day.

## What is a Community Day?

Our Community Days are open to everyone, and are packed with free performances, creative activities, and interactive workshops for all ages to enjoy.

This year, the Community Day forms part of the festival's **City Playground**, taking place here at **Curve, Phoenix cinema** just around the corner, and at **Leicester Museums & Galleries** on New Walk. Four Leicester schools have let their imaginations run riot, working with four inspiring local artists to create a fun-filled day across the three venues. We offer a number of Community Days throughout the year – visit the **Community Activities** page on our website for details of future days: [curveonline.co.uk/get-involved/community-days/](https://curveonline.co.uk/get-involved/community-days/)

# Getting to Curve

Our address is **Curve, 60 Rutland Street, Leicester, LE1 1SB.**

Here is a map of where Curve is in the **Cultural Quarter**, and the surrounding area.



## Getting here by Car

There are a number of car parks close to Curve, with the multi-storey NCP Rutland Centre Car Park being the closest to our Theatre. **Customers are advised that none of the car parks detailed on this page are owned or managed by Curve or Leicester Theatre Trust Ltd.**

### **NCP Rutland Centre Car Park (Multi-storey)**

56 Halford Street, Leicester, LE1 1TQ

Access Spaces: 7 | Max Height: 1.93m

Curve visitors can park in the NCP Rutland Centre adjacent to Curve for **£7.95** when validated at Box Office, Green Room Café or Stage Door Bar during your visit.

If parking at NCP Rutland Centre between the hours of 5pm and 2am, you can access a cheaper rate of **£5.95** if you pay via the NCP ParkPass App, or **£6.95** if you pay your parking at the machines located in the NCP on the day.

#### **Southampton Street**

Leicester, LE1 1TG

Access Spaces: 4

Hourly charges from **£1\***

#### **Haymarket**

Leicester, LE1 3HP

Access Spaces: 5

Hourly charges from **£1\***

#### **NCP Lee Circle Car Park**

Leicester, LE1 3RE

Access Spaces: 4 | Max Height: 1.93m

Hourly charges from **£1.95\***

#### **Newarke Street**

Leicester, LE1 5SN

Access Spaces: 1

Hourly charges from **£1\***

#### **Dover Street**

Leicester, LE1 6PW

Access Spaces: 14 | Max Height 1.98m

Hourly charges from **£1\***

#### **Highcross John Lewis Car Park**

Leicester, LE1 4QJ

Access Spaces: 109 | Family Spaces: 56 | Max Height, 1.98m

Hourly charges from **£3.50\***, plus flat evening rate of **£2.50\*** between 5pm and 6am.

There is also a drop-off point outside our theatre. \*Prices subject to change.

## Visual Story: Your Visit to Curve

**Curve** is a large, round building with a glass front, as shown below. The outside of Curve looks like this:



### **Halford Street Entrance**

what3words: ///wide.wiping.dared

### **Southampton Street Entrance**

what3words: ///seat.olive.quiet

### **Rutland Street Entrance**

what3words: ///driver.other.ideal

There are three main entrances into the building: **Halford Street**, by our **Green Room Café**; **Rutland Street**, by our **Box Office**; and **Southampton Street**, which is in between the two.

All entrances have a set of glass double doors. The doors will open outwards automatically as you move towards them. There is **level access** into the building from both entrances.

**Halford Street**



**Southampton Street**



**Rutland Street**



When you enter the building, you will be in the **Foyer**. Our **Foyer** is one big circle which wraps around two of our performance spaces – the **Theatre** and the **Studio Theatre**.

As you make your way around the **Foyer**, you will notice lots of large pictures on the big red walls. This is our **production gallery**, and features pictures from our previous shows.



There are also large digital screens throughout the building displaying upcoming shows and events, and information about the theatre.

What shows can you see in the production gallery and on the screens?



A number of **automatic hand sanitiser points** are available around the building. To use these points, simply hold your hand beneath the dispenser.

Push dispensers are also available around the building.

We will now take you on a visual tour of Curve if you were to enter though the **Halford Street** entrance.



Once through the glass doors, you will be in our **Foyer**. Our **Foyer** is one big circle, so you will always finish where you started.

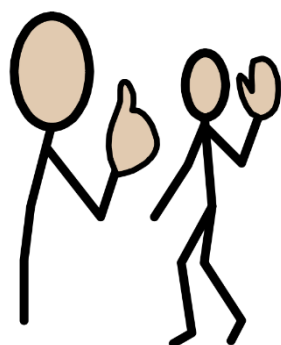

At the **Takeover Day**, you will be greeted at the entrance by team members from **The Spark Arts** and **Curve**. There will be a **welcome desk** to your right where you can find out more about the activities taking place throughout the day.



Start your visit in our **Green Room Café** – renamed for the day as the **Sit-In-Kitch-en!** - on your right. You can enjoy hot and cold drinks, snacks, and special combo deals curated by the schools behind the day.

On your left, you'll find **male, female** and **accessible toilets**. The toilets look like this:



**Male Toilet Door**



**Female Toilet Door**

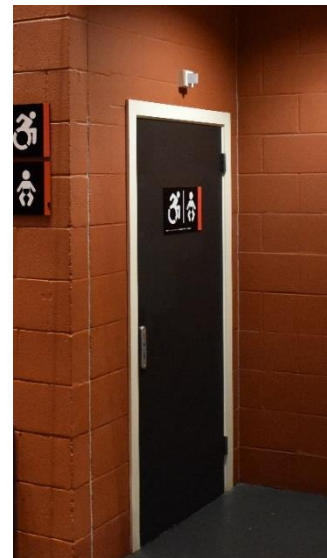

**Accessible Toilet Door  
(with Baby Changing)**



Continuing straight on you will approach our **Studio Theatre**, where you can **make your own musical instruments!**

You can enter the **Studio Theatre** through **Door 1**, which will be on your right.





The **Studio Theatre** look like this. On the day, arts and crafts tables will be placed in front of the seating.



Further along the **Foyer** near the **Foyer Seating Area** – which will be in front of you - you will see our **Public Lift** on your right, just next to **Theatre Door 3**.

If you are seeing **Palaver Party** in **Rehearsal Room 2** as part of your day, you can use this lift to access the **Mezzanine Floor**, where the space is located.



Straight ahead in the **Foyer Seating Area** - you will be able to **make your own puppets** at our drop-in arts and crafts tables.

Opposite the seating, you will find **Alcove 3**, where **Comment Corner** can be found at various times throughout the day.



Continuing past the **Foyer Seating Area**, you will find our **Stage Door Reception** desk on your left. Here, you can ask for directions or any other information you may need.

There is also a **staircase to the Mezzanine Floor** to the right of **Reception**, if you would prefer not to take the **Public Lift to Rehearsal Room 2**.

There are 30 steps over four flights to the **Mezzanine Floor**. The flights are split into 7, 8, 7, 8 steps in an anti-clockwise direction, with a landing between each flight.



Following the **Foyer** round, you will find our **Box Office** on your left. Here, you can find out more or book for upcoming shows.

If you have parked in the **NCP Rutland Centre Multi-storey Car Park** next door, you can also validate your car parking ticket here for **£7.95**.

There might be a small queue at the **Box Office** as other visitors will be collecting tickets or asking questions.



Opposite the **Box Office** is **Alcove 4** where you'll find the **Selfie Station**, with a camera and dressing up outfits and props. Strike a pose!



Just past **Alcove 4** on the right is our **Changing Places Facility**, with adult hoist. Please note you will need to bring your own hoist straps to use this facility.

← The door looks like this



Following the building round along the window, you'll find the **Schools Gallery** displaying fantastic artwork by local pupils, plus the interactive **Pledge Bunting** where you can share the causes close to your heart.

You will then find yourself back in our **Green Room Café** (or **Sit-In-Kitch-en**), where you started your day.

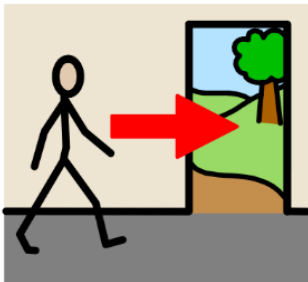

Activities on the day will be running between **11am** and **3pm**.

You can leave Curve via the **Halford Street** or **Rutland Street** doors when you are ready.

# Takeover Day Schedule

## Free activities and Performances – All Day

| Activity                                                  | Where                 |
|-----------------------------------------------------------|-----------------------|
| Make your own Musical Instruments                         | Studio Theatre        |
| Make your own Puppets                                     | Foyer Seating Area    |
| Musical Moments with<br>Gemma Fuller & Marcus Joseph      | Across the Foyer      |
| Bamboozle: Meet the Firebird                              | Across the Foyer      |
| Comment Corner                                            | Alcove 3              |
| Selfie Station                                            | Alcove 4              |
| Schools Gallery                                           | Foyer Windows         |
| Pledge Bunting                                            | Foyer Windows         |
| Sit-In-Kitch-en                                           | Green Room Café       |
| Short Films: Celebrating Spark Festival &<br>Venta Centre | Foyer Digital Screens |

## Ticketed Events

### Palaver Party

2pm – 4pm | Rehearsal Room 2

This performance is currently **sold out**. Please visit the Box Office for any returns on the day.

# Activity Map

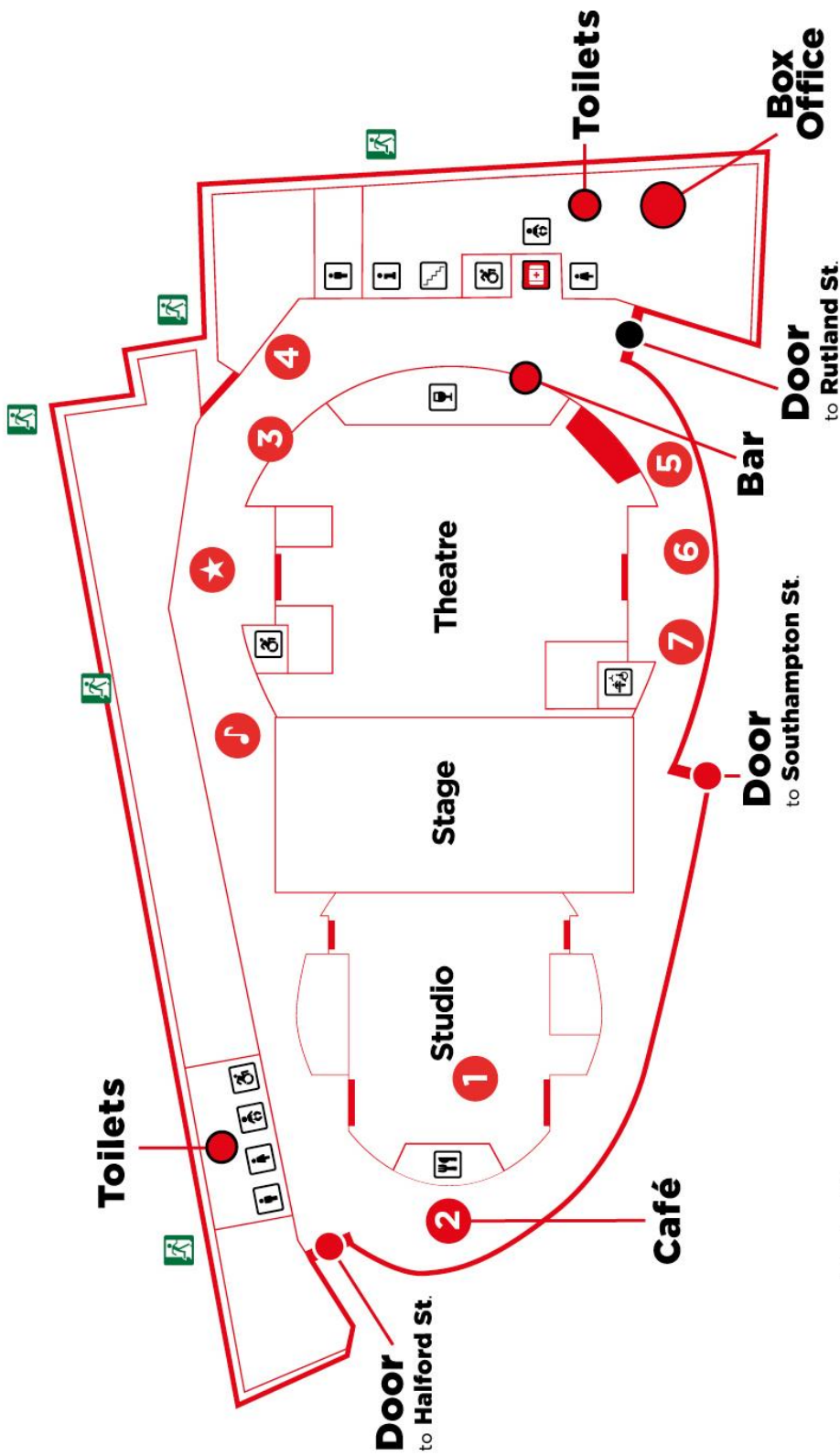

- 1** Make your own Musical Instruments
- 2** Sit-In-Kitchen
- 3** Comment Corner
- 4** Make your own Puppets
- 5** Selfie Station
- 6** Schools Gallery
- 7** Pledge Bunting

- 🎵** Musical Moments with Gemma Fuller & Marcus Joseph (across the foyer)
- ★** Bamboozle: Meet the Firebird (across the foyer)

## Palaver Party: Show Information

**Palaver Party** will take place in **Rehearsal Room 2** on our **Mezzanine Floor**.

Here is a picture of **Rehearsal Room 2**. The seating bank pictured will be pushed back against the wall, to allow space for the arts and crafts, activities and performances that will take place during the party!



To get to the **Mezzanine Floor**, you will need to take the **Public Lift** or the **staircase** next to our **Stage Door Reception**, as pictured on **page 8** of this pack.

If you take the **Public Lift**, turn right out of the lift when you reach the **Mezzanine Floor** and follow the corridor around to the bridge. Turn left, and make your way over the bridge.

If you take the **staircase**, turn left when you get to the **Mezzanine Floor**, go through the door in front of you, and then turn left again.



From there, you'll see the corridor pictured to the left. Follow it round to the right onto our open **Mezzanine** balcony.



If you turn right at this point, you will find our **gender neutral toilets** and an **accessible toilet**, just down the next passage on the right.



As make your way onto the balcony, you will see an open door on your left on the large brick wall, where a member of our **Visitor Experience Team** will be on hand to greet you and check your tickets.

← This is what the door looks like when it is closed.

When you enter the **Rehearsal Room 2**, the lights will be on and it may be noisy as the audience will be excited for the event to start. You might like to **wear ear defenders** to soften the noise, and bring a comforter or toy to play with before the performance starts. Some of the performers will welcome you to the party, and help you settle into the space.

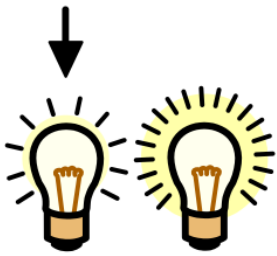

When the party is about to start, the lights in **Rehearsal Room 2** will be dimmed but it will never go completely dark. The door will remain open throughout the event, so you can leave the space at any time and return when you're ready.



During **Palaver Party**, you'll enjoy a range of activities including:

- Arts and crafts sessions
- Games
- Performances
- Story readings
- Opportunities to sing and dance!

Some moments will be loud or have bright lighting, whilst others will be quieter or have with softer lighting.

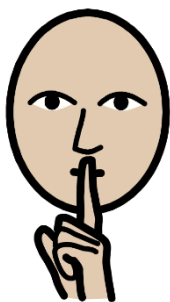

You can take part in as much or as little of the party as you'd like. If you would like a break from the party, you can take a seat on our **Mezzanine** balcony. Fidget toys can also be provided if you haven't brought your own – just speak to a member of our **Visitor Experience Team**.

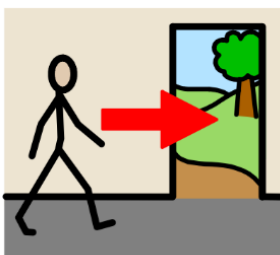

At the end of the party, the lights will get brighter. You can leave **Rehearsal Room 2** when you are ready to.



# Palaver Party Production Gallery





**We hope you find this information pack helpful ahead of your visit to Curve. Enjoy your day!**

If you have any comments on this information pack, please email us on **[access@curvetheatre.co.uk](mailto:access@curvetheatre.co.uk)**.

For more information about Accessibility at Curve, please visit **[www.curveonline.co.uk](http://www.curveonline.co.uk)**, or call our **Box Office** on **0116 242 3595**.

This information pack was created by **Nicola Allen**, Audience Development and Access Officer at Curve.