



Relaxed Performance Information Pack for Oi Frog & Friends!

Saturday 19 February, 10.30am



Box Office Telephone: 0116 242 3595

Box Office Email: tickets@curvetheatre.co.uk

Address: Curve, 60 Rutland Street, Leicester, LE1 1SB



Contents

Hello and What is a Relaxed Performance?.....	2
Important Information for Your Visit.....	3
Getting to Curve.....	4 - 5
Visual Story: Your Visit to Curve.....	6 – 13
Visual Story: Oi Frog & Friends!.....	14
Production Gallery.....	15

Hello!



We are looking forward to welcoming you to **Curve** for our **Relaxed Performance of Oi Frog & Friends!** We hope you are excited to see the show!

This pack is designed to give you a bit more information about the performance and our theatre ahead of your visit.

What is a Relaxed Performance?

Relaxed Performances are open to everyone but are especially tailored to support audiences with additional needs who may benefit from a more relaxed performance environment. This may include children, young people and adults with neurodivergence, such as autism, learning difficulties and other sensory or communication needs.

Throughout the performance the lights will remain on at a low level, and whilst the **Studio** doors will be closed, audience members will be free to come and go from the **Studio** if they need a break from the performance. There is also a relaxed attitude to noise during the show, and the sound and lighting will be adapted to more comfortable levels.

Important Information for Your Visit

Whilst the wearing of face masks is no longer mandatory from **Thursday 27 January 2022**, we are continuing to ask all audience members to wear a face covering once inside our building, and whilst watching the performance (except when eating and drinking).



We understand some visitors are unable to wear a face covering for health or well-being reasons and ask that you please consider a face shield or visor instead.

Whilst it is not a requirement for entry to our building and we will not ask for proof, we encourage all audience members to take a **Lateral Flow Test** ahead of visiting us.

All members of Team Curve will keep wearing masks and continue to take part in a regular testing programme.



In addition to face coverings, we continue to have in place a number of Covid-safety measures throughout the building to ensure everyone is as safe as possible, including increased ventilation and enhanced cleaning.

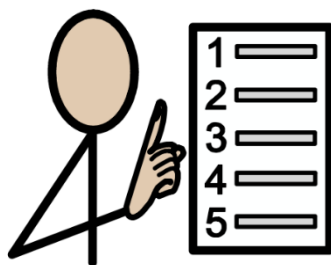

All Covid-safety measures are regularly reviewed in line with Government guidelines, please visit our website at www.curveonline.co.uk/plan-your-visit/faqs/ for the latest information.

Getting to Curve

Our address is **Curve, 60 Rutland Street, Leicester, LE1 1SB.**

Here is a map of where Curve is in the **Cultural Quarter**, and the surrounding area.



Getting here by Car

The nearest car park to Curve is the **NCP Rutland Centre Multi-storey Car Park**, next door to the theatre. The address for the car park is **56 Halford Street, Leicester, LE1 1TQ**. It has **seven** access spaces and a maximum height of **1.93m**.

Visitors to Curve can park at **NCP Rutland Centre Multi-storey Car Park** for a reduced rate of **£5.50** – please validate your car park ticket at our Box Office during your visit.

Other nearby car parks include **Queen Street Car Park (LE1 1QD, height restrictions apply)**, **NCP Lee Circle (LE1 3RE, four access spaces, maximum height 1.93m)** and **Highcross John Lewis Car Park (LE1 4QJ, 70 access spaces, maximum height 1.98m)**.

There is also a drop-off point outside our theatre.

Getting here by Bus

All Leicestershire bus services have stops within a three to 10-minute walk of Curve. Services that stop on or near **Humberstone Gate** or at **Haymarket Bus Station** are the closest.

Due to the temporary closure of **St Margaret's Bus Station**, regional bus services are currently terminating at alternative stops around the city. For more information, please see www.leicester.gov.uk/media/5k3bqvvd/smbs-replacement-stops-map.pdf, or contact service providers directly for the latest information on your service.

For more information on your nearest bus stop, visit the Leicester City Council website at www.leicester.gov.uk/transport-and-streets/travelling-by-bus/, or call **Traveline** on **0871 200 2233**.

Getting here by Train

Leicester Train Station is less than a 10-minute walk away via **Charles Street**. For the latest service information, please visit www.nationalrail.co.uk.

Visual Story: Your Visit to Curve

Curve is a large, round building with a glass front, as shown below.

The outside of Curve looks like this:



Halford Street Entrance

what3words: ///wide.wiping.dared

Rutland Street Entrance

what3words: ///driver.other.ideal

There are two main entrances into the building – one by our **Green Room Café** (Halford Street), and another by our **Box Office** (Rutland Street).

Both entrances have a set of glass double doors. Both doors can be opened by pressing the silver button on the wall or rail, but the Rutland Street doors will open outwards automatically as you move towards them.



There is **level access** into the building from both entrances.

When you enter the building, you will be in the **Foyer**. Our **Foyer** is one big circle which wraps around our two performance spaces – the **Theatre** and the **Studio**.



As you make your way around the **Foyer**, you will notice lots of large pictures on the big red walls. This is our **production gallery**, and features pictures from previous productions



A number of **automatic hand sanitiser points** are available around the building. To use these points, simply hold your hand beneath the dispenser.

Push dispensers are also available around the building.

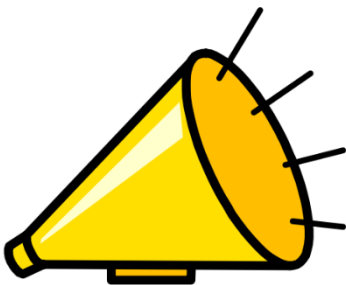

Before the show and during the interval, there will be some loud announcements in the **Foyer** telling you how long it is until the show begins, and other useful information about your visit. These will be at a quieter level during the **Relaxed Performance**.



It may also be noisy in the **Foyer** as other audience members will be arriving to see the show. You might like to cover your ears or wear a pair of ear defenders during this time.

Here is a map of the **Ground Floor** of our Theatre.

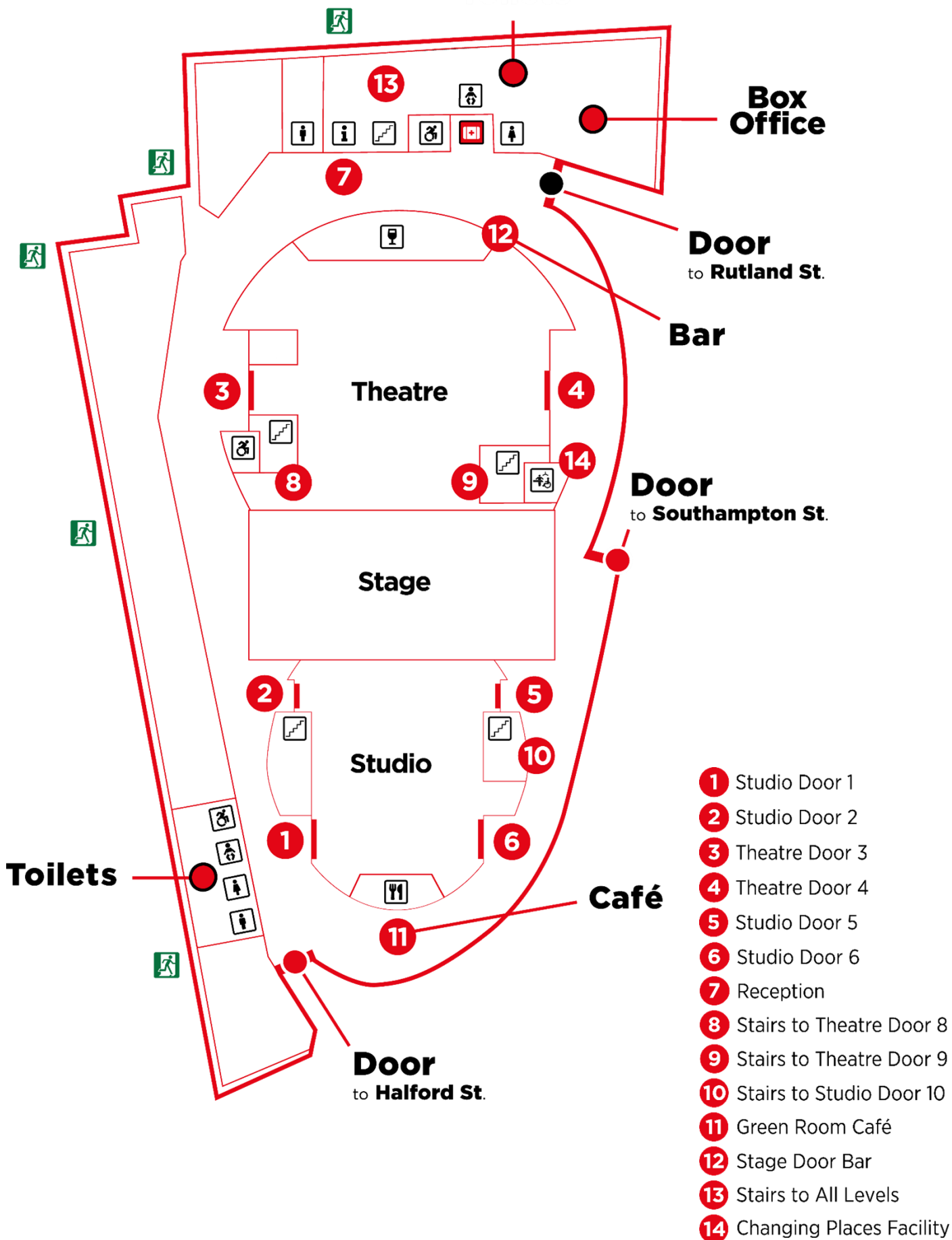

In the **Foyer** inside the Rutland Street doors, you will find our **Box Office**.



This is where you can collect your tickets for the show or buy tickets if you have not already booked.

Other audience members will also be collecting their tickets, so there might be a small queue.

Car parking tickets for cars parked in the **NCP Rutland Centre Multi-storey Car Park** next door to **Curve** can be validated at the **Box Office** for **£5.50**.



In the Foyer you will also find our **Green Room Café**.

Here you can buy a drink, snack or ice cream to enjoy before the performance.

There may be a small queue at the **Café**.

If you need to use the toilet before you take your seats, there are male, female and accessible toilets near the **Green Room Café** and **Box Office**.

All hand dryers will be turned off during the **Relaxed Performance**, and paper towels will be provided.

A **R.A.D.A.R** key is available at the **Green Room Café**.

The toilets look like this:



There is also a **Changing Places Facility** with adult hoist on the **Ground Floor** next to **Theatre Door 4**. Please note you will need to bring your own hoist straps to use this facility.

You will be watching **Oi Frog & Friends!** in the **Studio**. Here is a picture of the seats in the **Studio**. This is where you will sit to watch the performance.



Your **ticket** will tell you if you are sitting in the **Stalls** (ground floor, enter through **Studio Door 1** or **6**) or in the **Balcony** (upstairs, enter through **Studio Door 10**).

Your ticket will also tell you what door to enter through and where to sit.



A member of our **Visitor Experience Team** can help you find the right door and your seat by looking at the letters and numbers on your ticket. They will be wearing black shirts with a colourful Curve logo.

When you enter the **Studio**, the lights will be on and it may be noisy as the audience will be excited to see the show. You might like to **cover your ears** or **wear your ear defenders** to soften the noise and bring a toy to play with before the performance starts.

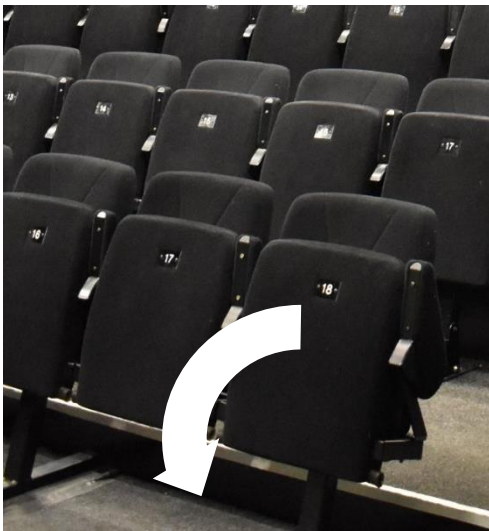

You will need to pull the bottom of your seat down to sit on it.

Booster seats are available if you can't see the stage comfortably, and a member of our **Visitor Experience Team** can get one for you.

They will also be happy to help you with anything else you may need to enjoy the performance.

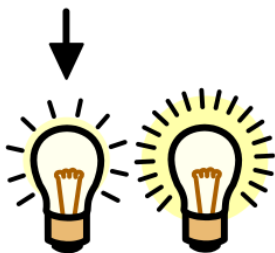

When the show is about to start, the lights in the **Studio** will be dimmed but it will never go completely dark.



Everyone will try to be as quiet as they can so they can listen to the story and music, but you are welcome to interact with the performance if you would like to!

The doors of the **Studio** will remain open throughout the performance, so you can leave the space and re-enter when you're ready should you need to use the toilet or take a break from the performance.



If you would like a break from the performance, you can visit our **quiet spaces** on the **Mezzanine** level, or in **Alcove 4** opposite **Box Office**.

You will need to take the stairs between **Studio Doors 5** and **6** to access the **Mezzanine**, and a member of our **Visitor Experience Team** can help you find it.



When the show has finished, the cast will come back onto the stage and bow. The audience will clap to show the cast they enjoyed the performance. You can also clap if you would like to!

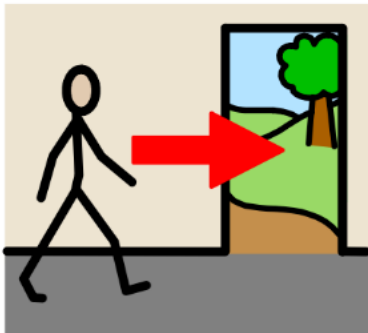

At the end of the show, the lights will get brighter. You can leave the **Studio** when you are ready.

Visual Story: Oi Frog & Friends!

For more information about **Oi Frog & Friends!**, we now invite you to read the Visual Story for the production which can be found on our website.

[Click here to read the Visual Story for Oi Frog & Friends!](#)

In the show's Visual Story, you will find information about:

- The length of the show
- Changes to the show
- What the show is about
- Things to look out for
- Characters in the show
- A summary of the story (contains spoilers!)

If you have any questions about the show or its content, please contact Fiona Bradley on fiona@kennywax.com or call her on 0207 437 1736.

Production Gallery

These photographs feature the original 2019 cast of **Oi Frog & Friends!**





We hope you find this information pack helpful ahead of your visit to Curve. Enjoy the show!

If you have any comments on this information pack, please email us on **access@curvetheatre.co.uk**.

For more information about Accessibility at Curve, please visit **www.curveonline.co.uk**, or call our **Box Office** on **0116 242 3595**.

We look forward to welcoming you.

This information pack was created by **Nicola Allen**, Audience Development and Access Officer at Curve, in collaboration with **Kenny Wax Family Entertainment**.