



Dementia Friendly Performance Information Pack for West Side Story

Wednesday 8 January, 2.15pm



Box Office Telephone: 0116 242 3595

Box Office Email: tickets@curvetheatre.co.uk

Address: Curve, 60 Rutland Street, Leicester, LE1 1SB

Contents

Welcome.....	2
Getting to Curve.....	3 - 4
Show Warnings.....	5
Useful Information.....	5 - 6
West Side Story – The Story.....	7 - 10
Visual Story: Your visit to Curve.....	11 - 20
Production Images.....	21

Hello!

We are looking forward to welcoming you to **Curve** for our **Dementia Friendly Performance of West Side Story**. We hope you are excited to see the show!

This pack is designed to give you a bit more information about the performance and our theatre, to help you prepare for your visit.

What is a Dementia Friendly Performance?

Our **Dementia Friendly Performances** are tailored to meet the specific needs of people living with Dementia. They include adaptations to the show, clearer visual markers and signage around the theatre, and a relaxed attitude to movement and audience responses during the show.

Getting to Curve

Our address is **Curve, 60 Rutland Street, Leicester, LE1 1SB.**

Here is a map of where Curve is in the **Cultural Quarter**, and the surrounding area.



Getting to Curve

Getting here by Car

The nearest car park to Curve is the **NCP Rutland Centre Car Park**, next door to the theatre. The address for the car park is **56 Halford Street, Leicester, LE1 1TQ**, and it has **seven** access spaces.

Visitors to Curve can park at **NCP Rutland Centre** for a reduced rate of **£5.50** – please show your ticket at our **Green Room Café, Stage Door Bar** or **Box Office** to receive this discounted rate.

Other nearby car parks include **Queen Street Car Park (LE1 1QD)**, **NCP Lee Circle (LE1 3RE, four** access spaces) and **Highcross John Lewis Car Park (LE1 4QJ, 70** access spaces).

There is also a drop-off point outside our theatre.

Getting here by Bus

All Leicestershire bus services have stops within a three to 10 minute walk of Curve. Services that stop on or near **Humberstone Gate** or at **Haymarket Bus Station** are the closest.

Regional bus services terminate at **St Margaret's Bus Station, Gravel Street, LE1 3AG** (12 minutes' walk from Curve).

For more information on your nearest bus stop, visit www.leicester.gov.uk/transport-and-streets/travelling-by-bus/, or contact **Traveline** on **0871 220 2233**.

Getting here by Train

Leicester Train Station is less than a 10-minute walk away via **Charles Street**.

Show Warnings



Warning

West Side Story contains **violence**, themes that may be **unsuitable for children**, **loud sounds**, a **gun shot**, **smoking on stage**, **semi nudity** and **theatrical haze**. More details can be found in the **Useful Information** section below.

If you have any concerns about the content of **West Side Story**, please email us on access@curvetheatre.co.uk or speak to a member of our **Visitor Experience Team** on the day.

Useful Information



The approximate running time for **West Side Story** is **2 hours and 15 minutes**, including a **20-minute interval**.

The show will start at **2.15pm**, and finish at **approximately 4.30pm**. **Act 1** is **1 hour 10 minutes** and **Act 2** is **45 minutes**.

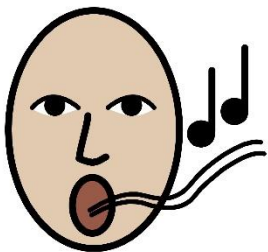

Singing

West Side Story is a **musical**, so there will be lots of **singing** throughout the performance.

The music in the show is performed live by a **15-piece orchestra** conducted by our Musical Director **George Dyer**, and sang by members of the company.



Dancing

You will see the **orchestra** on a balcony at the back of the stage at selected moments throughout the show.

There will also be lots of **dancing** throughout the performance. You can sing and dance along during the show if you would like to!

Useful Information

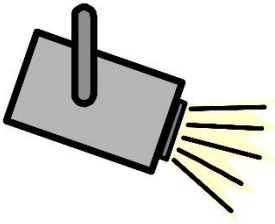

Lights

There will be different lighting states throughout the show, with some moments in brighter lighting and other moments in darker lighting.

There will be no strobe lighting during this performance, and the lights in the auditorium will also remain on at a low-level during the performance.

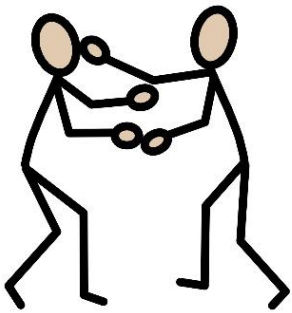

Fighting

There will be some scenes in the show where the **Jets** and the **Sharks** fight with each other. During one of the fights, a member of each gang is also stabbed with a knife and will appear to pass away.

The knife used in the show is not real and no-one is actually being hurt, however the actors have been specially trained in stage fighting to make these moments look real.



Gun

In the last scene of the show, one of the **Jets** is shot with a gun by one of the **Sharks**. There will be a **quick, loud bang**, and the actor who has been shot will appear to pass away.

The gun used in the show is not real and no-one has really been hurt.

West Side Story – The Story

Look for the 🎵 as this shows where the songs are during the show!

Act 1

Our show begins at the **Immigration Station, Ellis Island** and other locations around **New York** as the Puerto Rican **Sharks** make their way into the **Jets'** American neighbourhood. There's a disagreement between the rival gangs, which is stopped by **Lt. Schrank** and **Officer Krupke** (🎵 **Prologue**).

Desperate to keep a grip on their neighbourhood, the leader of the **Jets - Riff** – suggests they challenge the **Sharks** to a fight – called a **rumble**. He plans to invite the **Sharks'** leader **Bernardo** to the fight that night at the neighbourhood dance (🎵 **Jet's Song**).

Riff visits his friend **Tony** - a former member of the **Jets** - at **Doc's Drugstore** (a shop), where **Tony** works. **Riff** wants **Tony** to come along to the dance. **Tony** doesn't want to at first but soon agrees. He also feels something good is about to happen (🎵 **Something's Coming**).

In a **bridal shop** we meet two of the **Shark** girls, **Maria** and **Anita**. **Maria** is the sister of **Bernardo**, and **Anita** is **Bernardo's** girlfriend. **Maria** is to be married to **Bernardo's** friend **Chino**, but she tells **Anita** that she is not in love with him.

Later that evening we go to the neighbourhood dance.



A challenge dance takes place between the rival gangs (🎵 **The Dance at the Gym Blues**, 🎵 **Promenade**, 🎵 **Mambo**, 🎵 **Cha-Cha**).

Tony and **Maria** spot one another across the room. Despite the tensions on the dancefloor, they dance together and fall in love.

West Side Story – The Story

Bernardo is unhappy with **Tony** and **Maria** dancing together and asks **Chino** to take his sister home. As another disagreement breaks out, **Riff** and **Bernardo** agree to meet later at **Doc's** shop.



Desperate to see Maria again (♪ **Maria**), **Tony** finds her building. They get to know each other better and agree to meet again at the bridal shop (♪ **Balcony Scene**, ♪ **Tonight**).

In the meantime, **Shark** girls **Anita**, **Rosalia** and **Consuelo** are discussing whether Puerto Rico or America is the better place to live, with **Anita** liking America and **Rosalia** liking Puerto Rico (♪ **America**).

At **Doc's** shop, the **Jets** are keen to start the fight. **Riff** encourages them to let out their aggressions (♪ **Cool**), as the **Sharks** arrive to discuss the details of the fight.

As things get heated, **Tony** arrives and suggests the fight should just be a fist-fight, with no weapons involved. There's a whistle to mark the arrival of **Lt. Schrank**.

The gangs quickly talk to each other and act like nothing is going on, but **Schrank** knows better and tries to find out where the fight will be taking place. As the gangs leave **Doc's** shop, **Tony** tells Doc about his love for **Maria**.

The next day at the **bridal shop**, **Maria** is helping **Anita** to close the store, excited to see **Tony** again. **Anita** tells **Maria** about the fight, just as **Tony** arrives, picks **Maria** up and spins her around with a smile.

West Side Story – The Story

After **Anita** leaves the store, **Maria** asks **Tony** to stop the fight and he agrees to. Before he goes, the couple imagine their wedding, using two small scraps of fabric as ‘rings’ (♪ **One Hand, One Heart**).



The gangs prepare for the fight (♪ **Tonight Quintet**), before meeting **under the Highway**. **Tony** arrives as the fight begins and tries to stop it, but the rival gangs continue to sneer, punch and kick one-another (♪ **The Rumble**).

Riff draws a knife and tries to hurt **Bernardo**, but **Bernardo** turns him around and stabs him. Angry, **Tony** quickly grabs the knife and kills **Bernardo** as the curtain falls and the gangs run away.

Act 2



At the start of **Act 2**, we join **Maria**, **Rosalia** and **Consuelo** in the **bridal shop** as she continues to daydream about seeing **Tony** again (♪ **I Feel Pretty**).

As **Rosalia** and **Consuelo** leave, **Chino** arrives and tells **Maria** that **Tony** has killed her brother, **Bernardo**.

Maria insists that **Chino** is lying, shouting at him to leave the shop. **Tony** arrives and she hits his chest with sadness, but she still loves him. As they agree to run away together, we go to a dream world where everyone is friendly and peaceful (♪ **Somewhere**).

West Side Story – The Story



We re-join the **Jets** after the fight in a street on the **West Side**. To cheer themselves up, they mock **Officer Krupke** and the other adults who don't understand them with a silly song called 🎵 **Gee, Officer Krupke**.

Jet girl Anybodys arrives and tells the boys that she has been spying on the **Sharks**. She has found out that **Chino** is looking for **Tony** with a gun. The **Jets** set out to find **Tony**.

Maria and **Tony** have spent the night together. Sad after losing **Bernardo**, **Anita** arrives as **Tony** quickly leaves down the fire escape of the building – he tells **Maria** to meet him at **Doc's** shop. Angry that **Maria** has been with **Tony**, **Anita** tells her she should find another boy (🎵 **A Boy Like That**).

Maria tells **Anita** that she loves **Tony** (🎵 **I Have A Love**), and **Anita** tells her that **Chino** is out looking for him with a gun. As **Lt. Schrank** arrives to question **Maria** about her brother's death, **Anita** goes to **Doc's** shop to tell **Tony** to wait for **Maria**.

The **Jets** have gathered at **Doc's** shop as **Anita** arrives. They say and do lots of horrible things to her, but **Doc** breaks the group up. Feeling hurt, **Anita** tells the **Jets** that **Chino** has shot **Maria**. **Doc** tells **Tony** the news, and **Tony** goes out to find **Chino**.

Whilst searching the neighbourhood, **Chino** appears and shoots **Tony** with the gun just as he sees **Maria** running towards him. **Maria** holds **Tony** in her arms as he passes away. The gangs move towards **Maria** and **Tony**, but **Maria** takes **Chino's** gun, pointing it at crowd and telling them that they have all killed **Tony**. Upset, she sits beside his body, as the gangs gather round and the curtain falls (🎵 **Finale**).

Your Visit to Curve

Curve is a large, round building with a glass front.

The outside of **Curve** looks like this.



Halford Street Entrance

Rutland Street Entrance

There are two main entrances to the building – one by our **Green Room Café** (Halford Street), and another by our **Box Office** (Rutland Street).

Both entrances have a set of glass double doors. Both doors can be opened by pressing the silver button on the wall or rail, but the Rutland Street doors will open outwards automatically as you move towards them.

There is **level access** into the building from both entrances.

Your Visit to Curve

When you enter the building, you will be in the **Foyer**.

Our **Foyer** is one big circle which wraps around our two performance spaces – the **Theatre** and the **Studio** – so it's really easy to find your way around.

As you walk around the **Foyer** you may notice lots of large pictures on the big, red walls.

This is our **production gallery**, and features pictures from previous productions here at **Curve**.



There will be some loud announcements in the **Foyer** telling you how long it is until the show begins, and other useful information.

These will be at a quieter level during the **Dementia Friendly Performance**.



It may also be busy and noisy in the **Foyer** as other audience members will be arriving to see the show.

Your Visit to Curve

Here is a map of the **Ground Floor** of our Theatre.

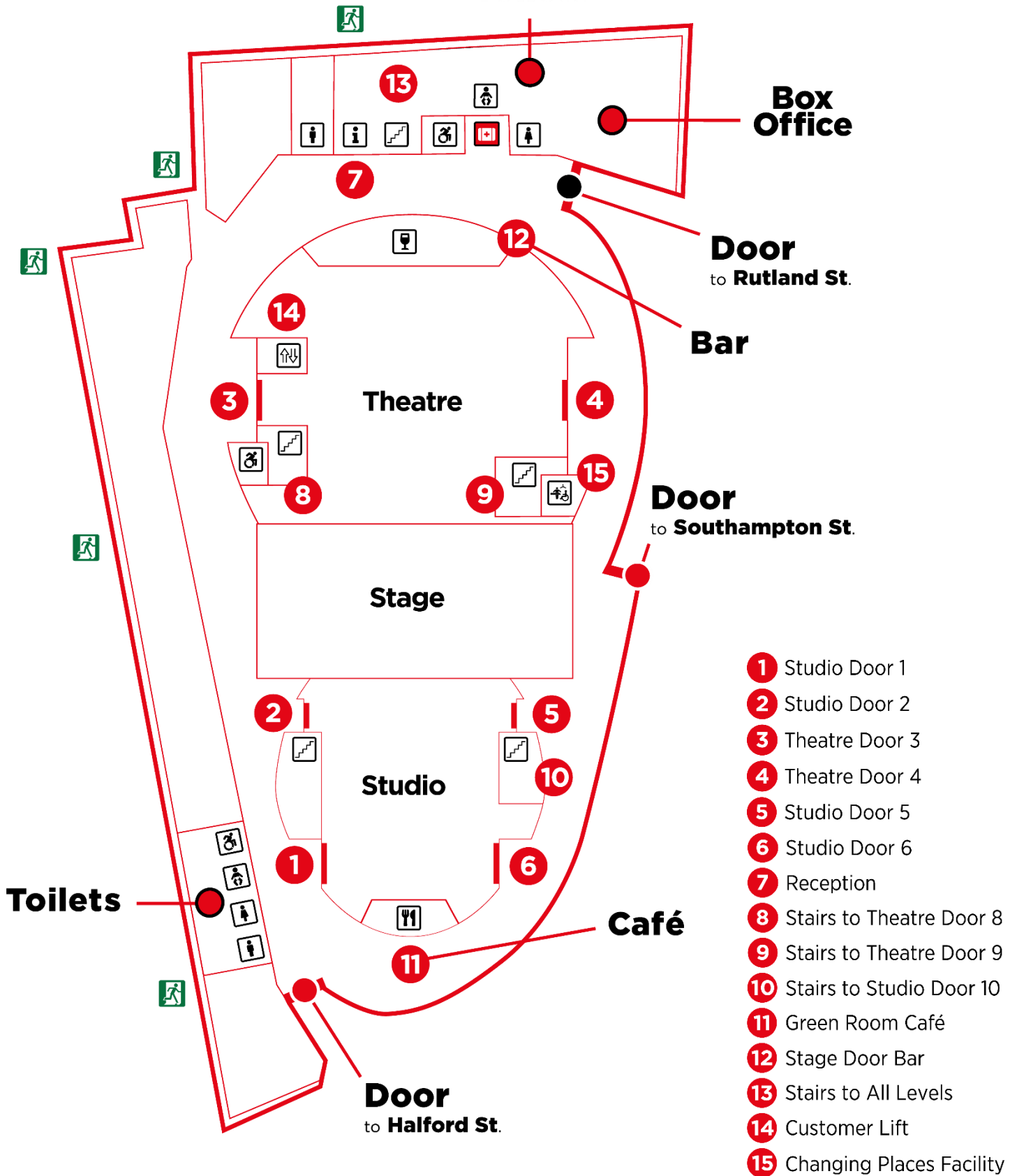

Your Visit to Curve

In the **Foyer** inside the Rutland Street doors, you will find our **Box Office**.

This is where you can collect your tickets for the show or buy tickets if you have not already booked.

Other audience members will also be collecting their tickets, so there might be a small queue.



Car parking tickets for cars parked in the **NCP Rutland Centre Car Park** next door to **Curve** can be validated at the **Box Office** for **£5.50**. This ticket is valid all day.

Your Visit to Curve

In the Foyer you will also find our **Green Room Café** and **Stage Door Bar**.

Here you can buy a drink, snack or ice cream to enjoy before the performance, or during the **interval**.

There may be a small queue at the **Café** before the performance and during the **interval**.



Free tea and coffee will be served in the auditorium during the interval of our **Dementia Friendly** performance. For all other refreshments, please visit our **Green Room Café** or **Stage Door Bar**.

Your Visit to Curve

If you need to use the toilet before you take your seats, there are male, female and accessible toilets near the **Green Room Café** and **Box Office**.

A **R.A.D.A.R** key is available at the **Green Room Café**. The toilets look like this.

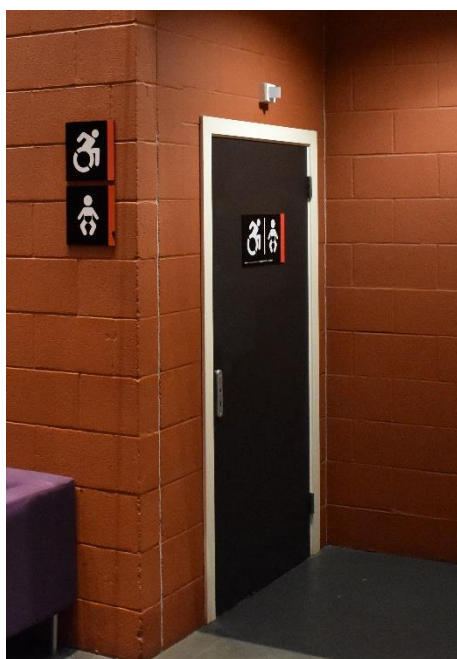

There is also a **Changing Places Facility** with adult hoist on the **Ground Floor** next to **Theatre Door 4**.

Your Visit to Curve

You will be watching **West Side Story** in the **Theatre**.

The **Theatre** is our biggest performance space at Curve, and there are lots of soft, red seats.

Your **ticket** will tell you if you are sitting in the **Stalls** (ground floor, enter through **Theatre Door 3** or **4**) or in the **Circle** (upstairs, enter through **Theatre Door 8** or **9**). Your ticket will also tell you what door to enter through and where to sit.

Here is a picture of the **Theatre**.

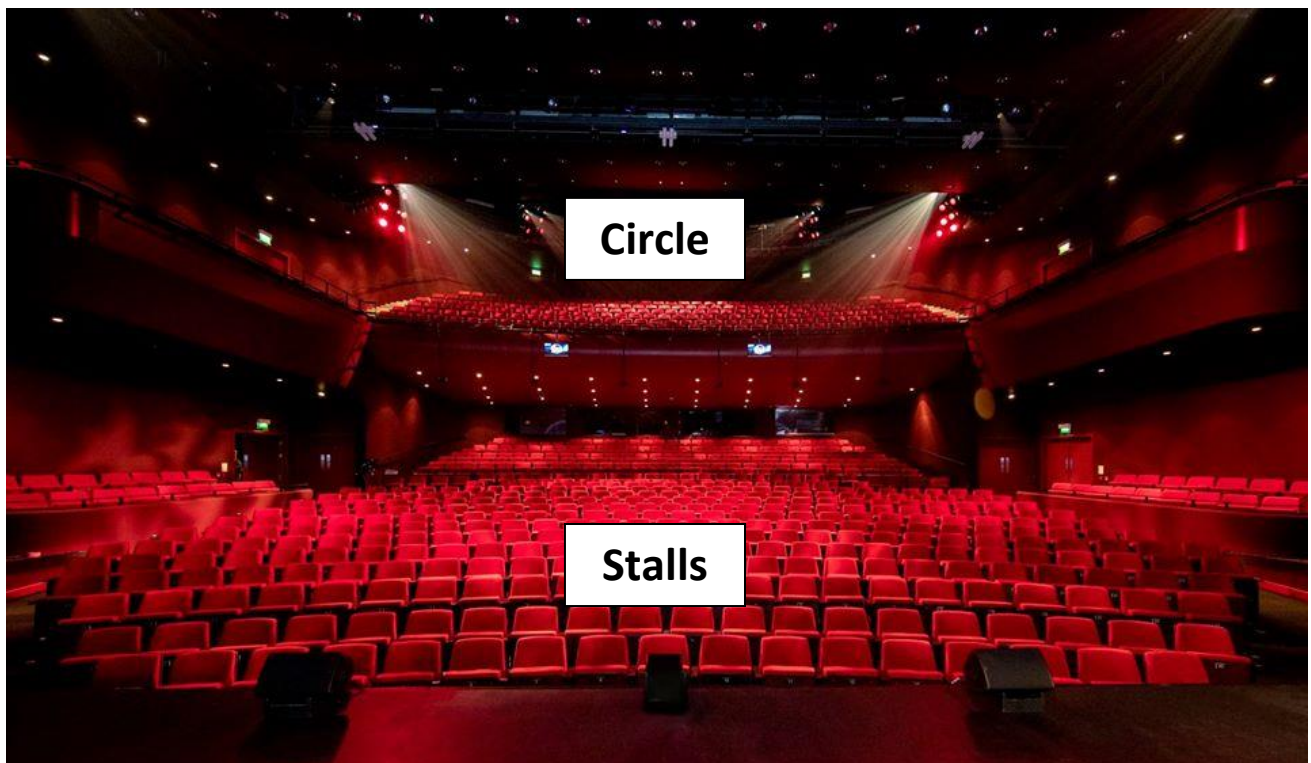

Your Visit to Curve

If you are sat in the **Circle**, you will have to climb a number of stairs or take the public lift next to **Theatre Door 3** to access **Theatre Door 8** or **9**.



A member of our **Visitor Experience Team** can help you find the right door and your seat by looking at the letters and numbers on your ticket.

The **Visitor Experience Team** will be wearing black shirts with a colourful Curve logo. There will also be **additional team members** around the building wearing red t-shirts with a white Curve logo on the front. You can ask them for any help you may need.



We will open the **Theatre** doors around **45 minutes** before the show starts, so you can find your seat and get comfortable in the space.

Your Visit to Curve

When you enter the **Theatre**, the lights will be on and it may be noisy as the audience will be excited to see the show.

You will need to pull the bottom of your seat down to sit on it.

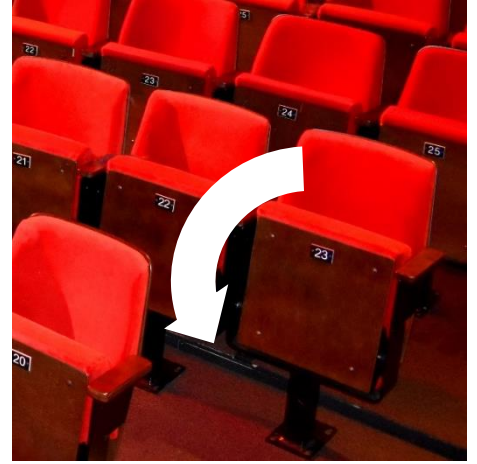

If you would like us to store your wheelchair or walker during the performance, or if you need assistance with transferring to a theatre seat, please speak to a member of our **Visitor Experience Team**.

When the show is about to start, the lights in the **Theatre** will be dimmed but it will never go completely dark.

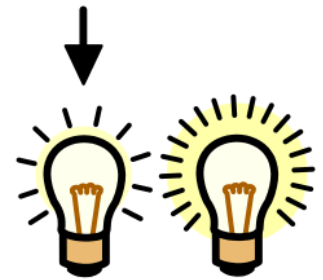

Lights dimmed

If you need a break from the performance, you can visit our **quiet space** in the **Studio**, next door to the **Theatre**. A member of our **Visitor Experience Team** can help you find it.

You can return to the performance when you are ready.

Your Visit to Curve

During the performance, there will be a **20-minute break** called an **interval**. The lights will get brighter and the **Theatre** will get noisier during this time.



In the **interval**, you can visit the **Green Room Café** for a drink or a snack, use the toilet, or just take a break from the **Theatre** space.

Interval

Free tea and coffee will be served in the auditorium during the **interval** of our **Dementia Friendly performance**. For all other refreshments, please visit our **Green Room Café** or **Stage Door Bar**.

When the **interval** has finished, the audience will come back into the **Theatre** and sit in their seats. It will get darker in the **Theatre** again.

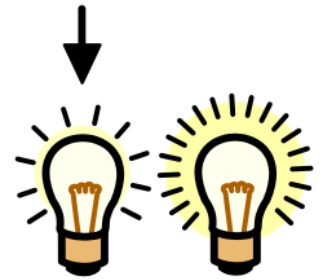

Lights dimmed

When the show has finished, the cast will come back onto the stage and bow. The audience will clap and cheer to show the cast they enjoyed the show.



Clapping

Our **West Side Story** cast members will also come into the **Theatre** to say hello to you after the performance. If you would like to meet our company, please stay in your seats at the end of the show.

Production Images



CURVE



We hope you find this information pack helpful ahead of your visit to Curve.

If you have any comments on this information pack, please email us on access@curvetheatre.co.uk.

For more information about Accessibility at Curve, please visit www.curveonline.co.uk, or call our **Box Office** on **0116 242 3595**.

We look forward to welcoming you!

Photography credits: Luke Billings, Matt Cawrey, Ellie Kurttz and Tom Wren.
Production Photography: Ellie Kurttz